

ITEM NO.	PART NUMBER	DESCRIPTION	QTY.
1	20-203-0	EPOXY BUSHING	1
2	SS-0225-02	COPPER CONDUCTOR ASSEMBLY	1
3	GA-0105-00	BUNA GASKET, 1/8" THK.	1

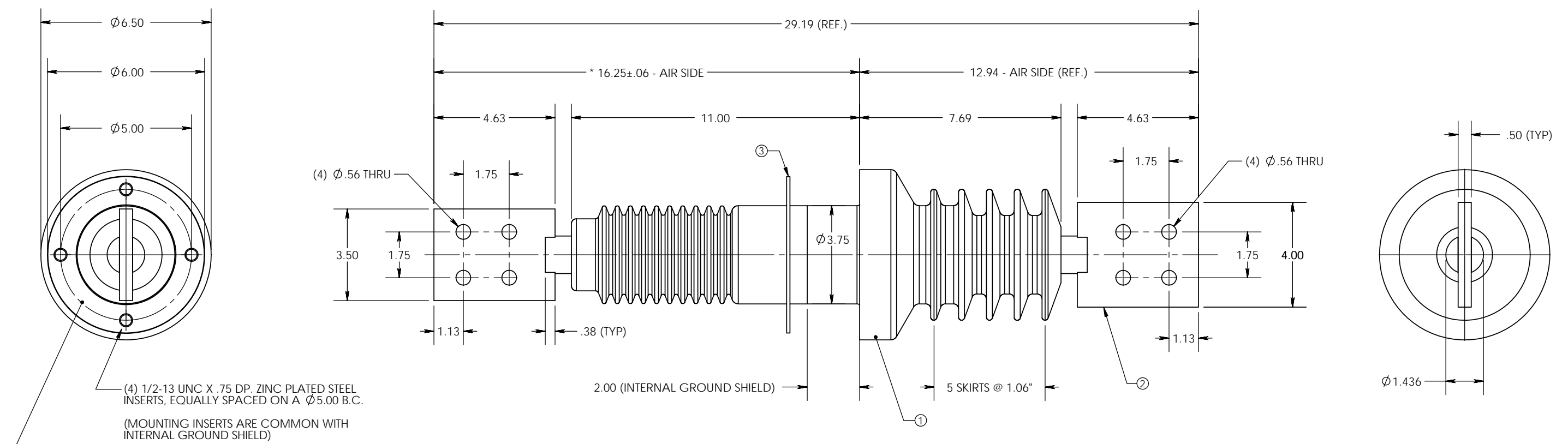

(4) 1/2-13 UNC X .75 DP, ZINC PLATED STEEL INSERTS, EQUALLY SPACED ON A ϕ 5.00 B.C.
(MOUNTING INSERTS ARE COMMON WITH INTERNAL GROUND SHIELD)
 ϕ 6.00 O.D. X ϕ 3.75 I.D. X .09 DP GASKET RETAINING GROOVE

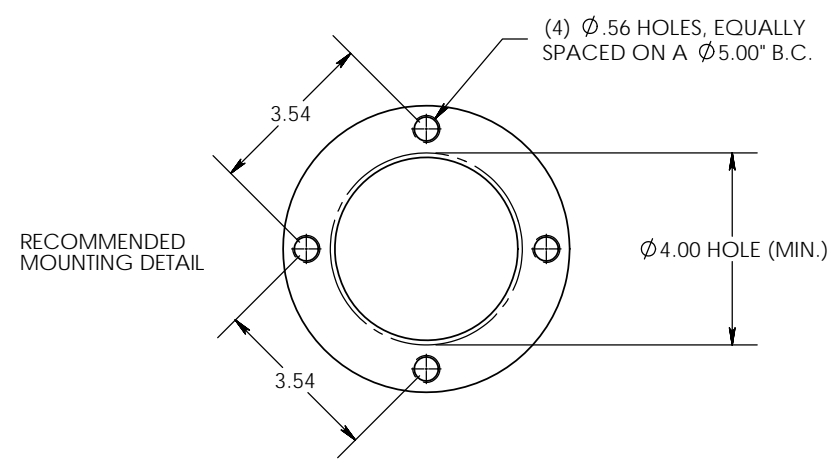

- NOTES:
1. ALL CONTACT SURFACES TO BE CLEAN & FREE FROM FLASH
- MATERIAL:
1. E07 - CYCLOALIPHATIC EPOXY (U.V. EXPOSED), COLOR: GREY
2. HD ETP COPPER C11000 GRADE COPPER, TIN PLATED
- SPECIFICATIONS:
1. MANUFACTURED IN ACCORDANCE WITH IEC 137-1995, CAN/CSA-C88.1-96, IEEE C57.19.01-1991
2. RATED VOLTAGE 15kV
3. POWER FREQUENCY WITHSTAND 50kV
4. BASIC IMPULSE LEVEL 110kV
5. NOMINAL CURRENT RATING 1200 AMPS
6. CREEP DISTANCE 15.75"/400 mm (27 mm/kV)
7. TEMPERATURE CLASSIFICATION..... -40 °C TO +105 °C
8. ESTIMATED WEIGHT 30 LBS

PROPRIETARY AND CONFIDENTIAL
THE INFORMATION CONTAINED IN THIS DRAWING IS THE SOLE PROPERTY OF THE H-J FAMILY OF COMPANIES. ANY REPRODUCTION IN PART OR AS A WHOLE WITHOUT THE WRITTEN PERMISSION OF THE H-J FAMILY OF COMPANIES IS STRICTLY PROHIBITED.

TOLERANCES (EXCEPT AS NOTED)
ONE PLACE MM ±1.50
TWO PLACE MM ±0.75
TWO PLACE DEC. ±.060
THREE PLACE DEC. ±.030
FRACTIONS ± 1/16"
ANGLES 2°

BREAK ALL SHARPS UNLESS OTHERWISE NOTED



THE H-J FAMILY OF COMPANIES
3010 HIGH RIDGE BLVD, HIGH RIDGE, MO. 63049 USA
PHONE 1-636-677-3421 FAX 1-636-376-1915

15kV / 1200A
POWER APPARATUS BUSHING

DRAWING NO. **20-203-001**

SCALE 1:4 SIZE B REV. 0 SHEET 1 OF 1